

TOORX
PROFESSIONAL LINE

INSTRUCTION



WBX3600



Cod : GRLDTOORXWBX3600

Rev : 00

Ed : 06/18

Training Area and Free Area

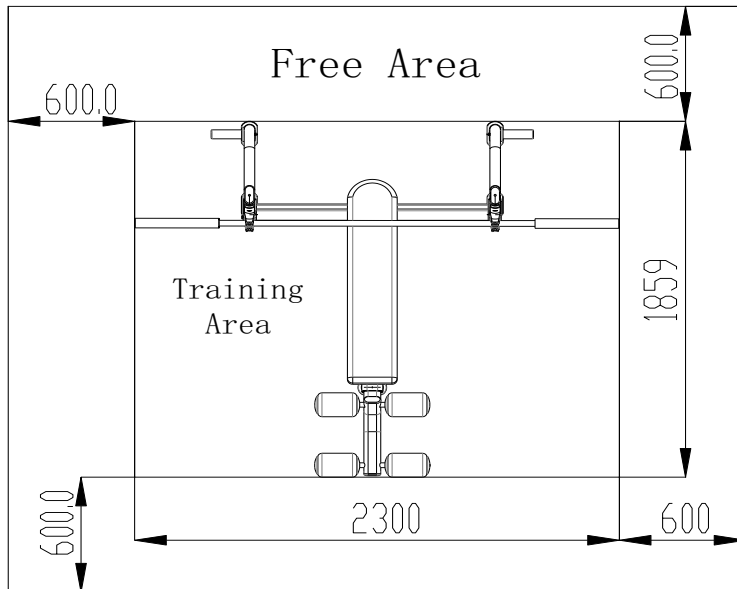

Specifications

Class: S

Maximum Wt. Capacity: 150kg/330IBS

Maximum User Weight: 135kg/297IBS

Product Total Surface: 2300*1859mm

Product Total Mass: 100kg/220IBS

REGULAR MAINTENANCE

1. The safety level of the equipment can be maintained only if it is examined regularly for damage and wear, e.g. ropes, pulleys, connection points;
2. Pay special attention to components most susceptible to wear.
3. Replace defective components immediately and /or keep the equipment out of use until repair;
4. This equipment should carry on regular maintenance according to the following chart:

MAINTENANCE	EVERYDAY	EVERY WEEK	THREE MONTHS
Check: connecting, bolt, Weight stack bolt	√		
Clearance: cushion and cover	√		
Lubrication: place of sliding			√
Check: bolt if tighten		√	
Lubrication: Bracket of bearing			√

INSTALL SKETCH MAP

Let assembly become easier

All the content of user's manual is to assured the strength training machine can be installed more easily

Reading the details and instructions before installing:

1. Because the size and weight of equipment is so large, Please choose the installed place near the desired station and assured there is enough space to exercise
2. All parts can be put on the clear area, then backout the wrapper. And the wrapper can't be through away before installation finished.
3. Screw the bolt tightly except the additional instruction
4. All parts must be installed according the illustration indication.
5. Installation work can be finished by tow men
6. Identify all parts by part identify chart

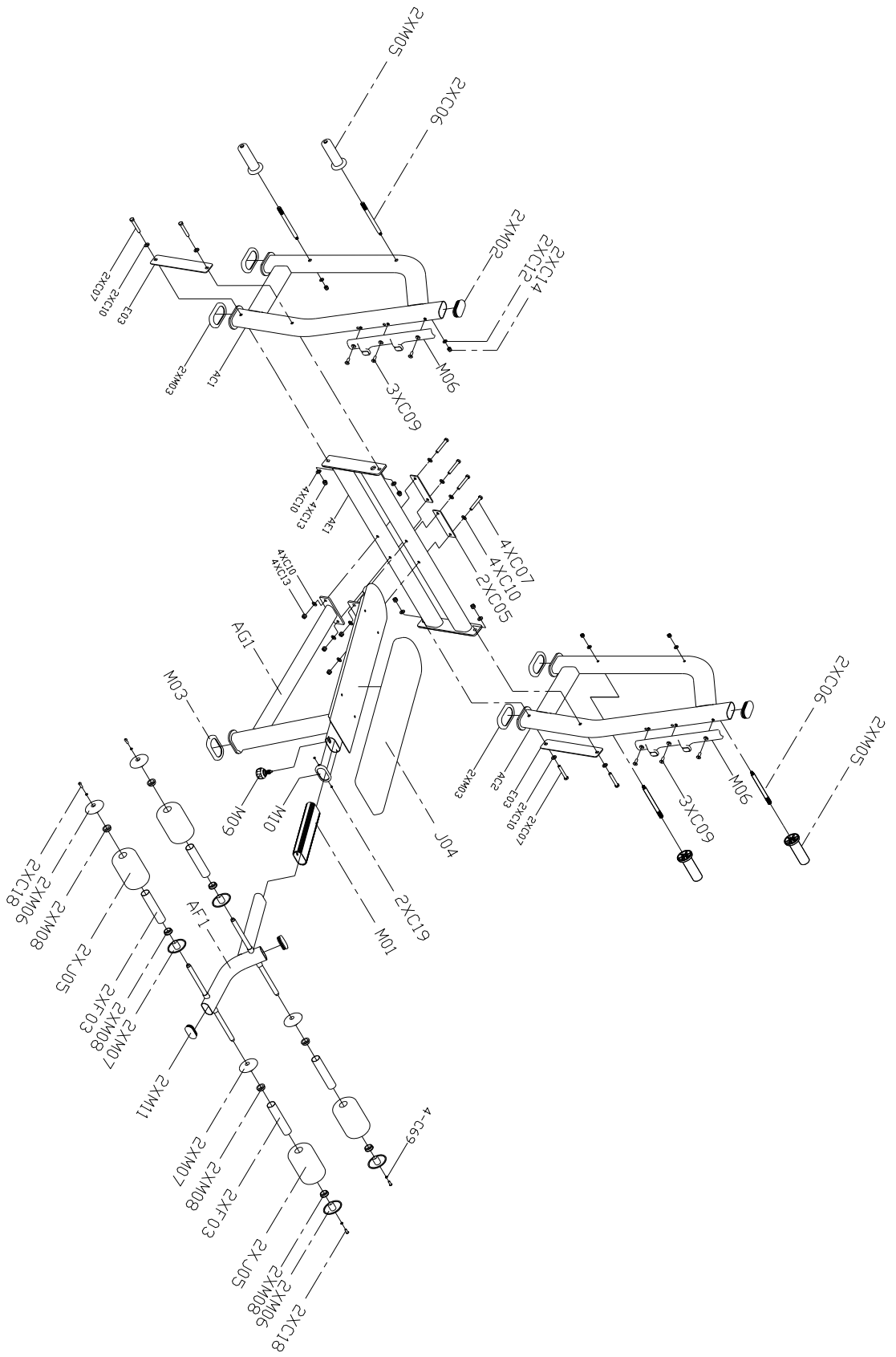

Assembly Step:

Use tool:

- 1. M6 Hex spanner**
- 2. Two 17-19 spanner**

Step1

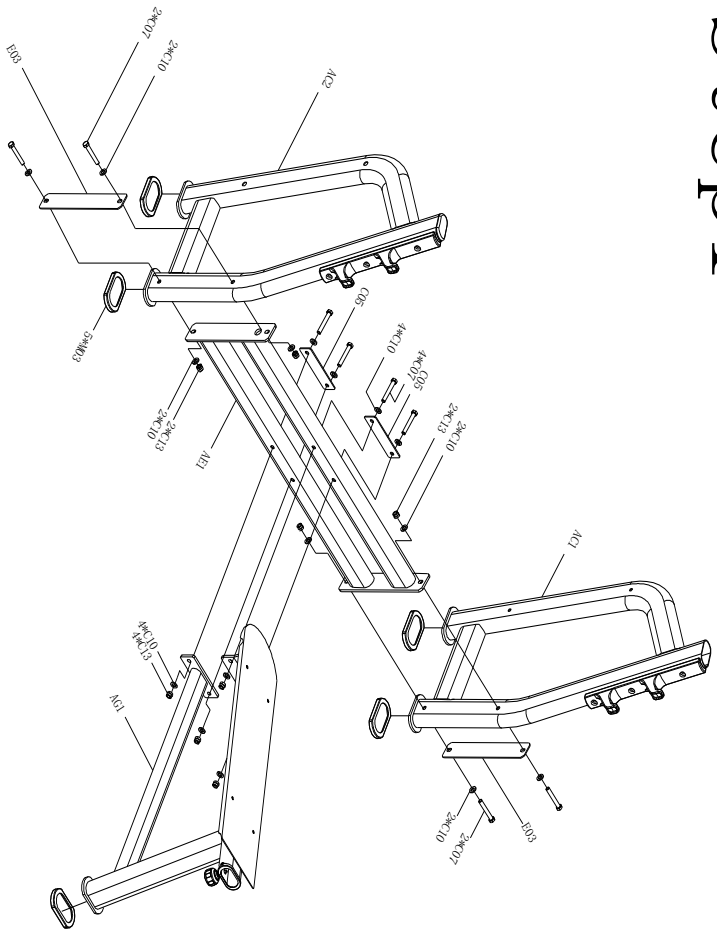

No	Name	Spec	Pcs
AC1	Main Frame		1
AC2	Main Frame		1
AC3	connecting bracket		1
AC4	Board welding		1
AC5	Supporting board	385L460W*8T	2
AC6	connecting board	180L460W*4T	2
AC7	hexagon screw	M12*1.75P-80L	8
AC8	Flat washer	φ 13.5* φ 24*2.5T	16
AC9	Lock nut	M12*1.75P	8
AC10	Flat elliptical rubber pad	φ 80*135	5

Step2

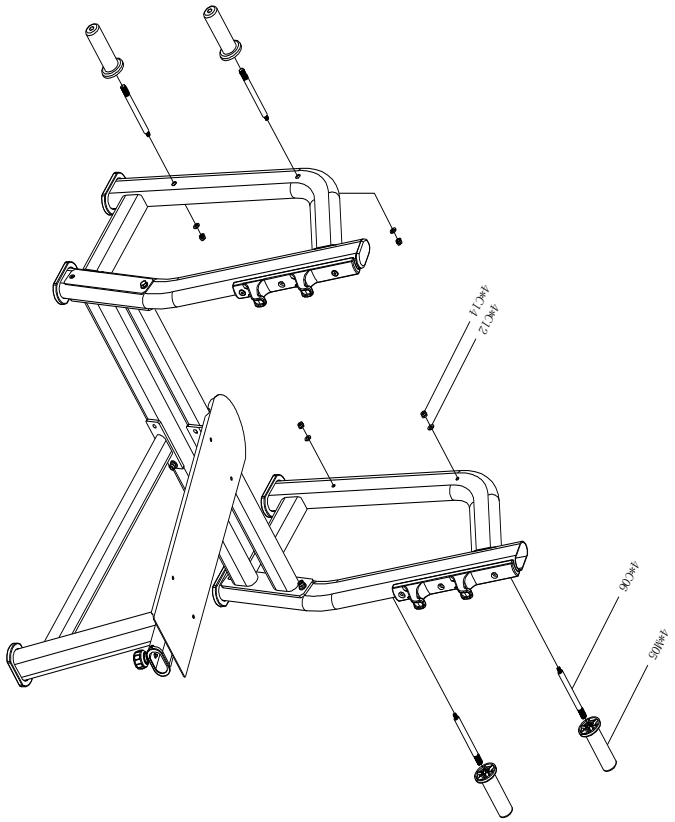

No	Name	Spec	Pcs
M05	plastic bar		4
C06	Bar of weight plate	φ 16*190L	4
C12	Flat washer	φ 11 * φ 20*2t	4
C14	lock nut	φ 11 * φ 20*2t	4

Step3

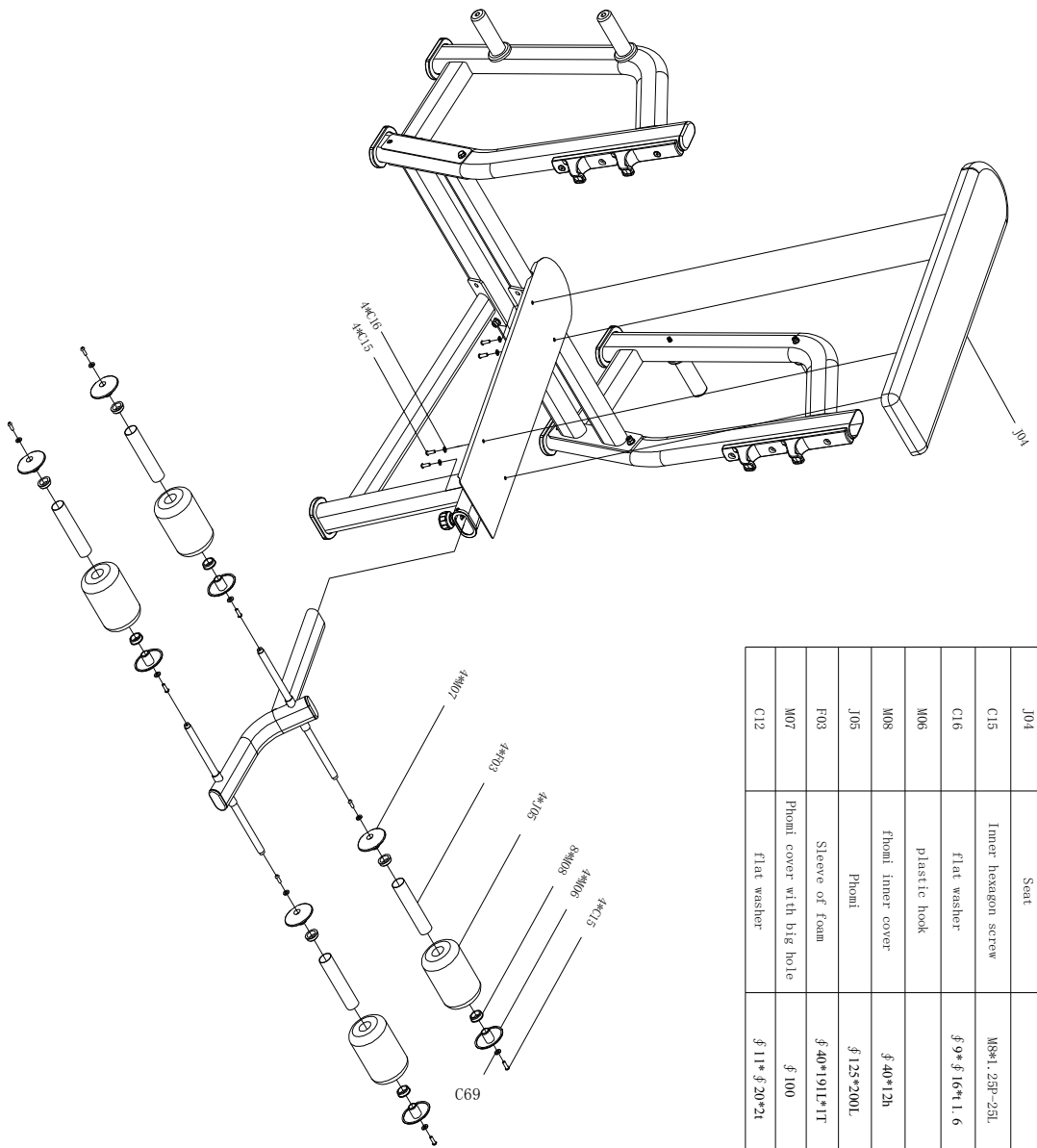

No	Name	Spec	Pcs
J04	Seat		1
C15	Inner hexagon screw	M8*1.25P-25L	8
C16	Flat washer	f 9* f 16*1.6	4
M06	plastic hook		4
M08	Phoni inner cover	f 40*12h	8
J05	Phoni	f 125*200L	4
FO3	Sleeve of foam	f 40*191L*1T	4
M07	Phoni cover with big hole	f 100	4
C12	Flat washer	f 11* f 20*2t	4

Adjust Instructions

Foam Height Adjustment

- 1、 Pull out the adjustable handle,adjust foam to suitable position,and loosen the handle.
- 2、 After finish adjusting,please ensure that the bolt of the adjustable handle is inserted to pin hole completely before using the equipment.

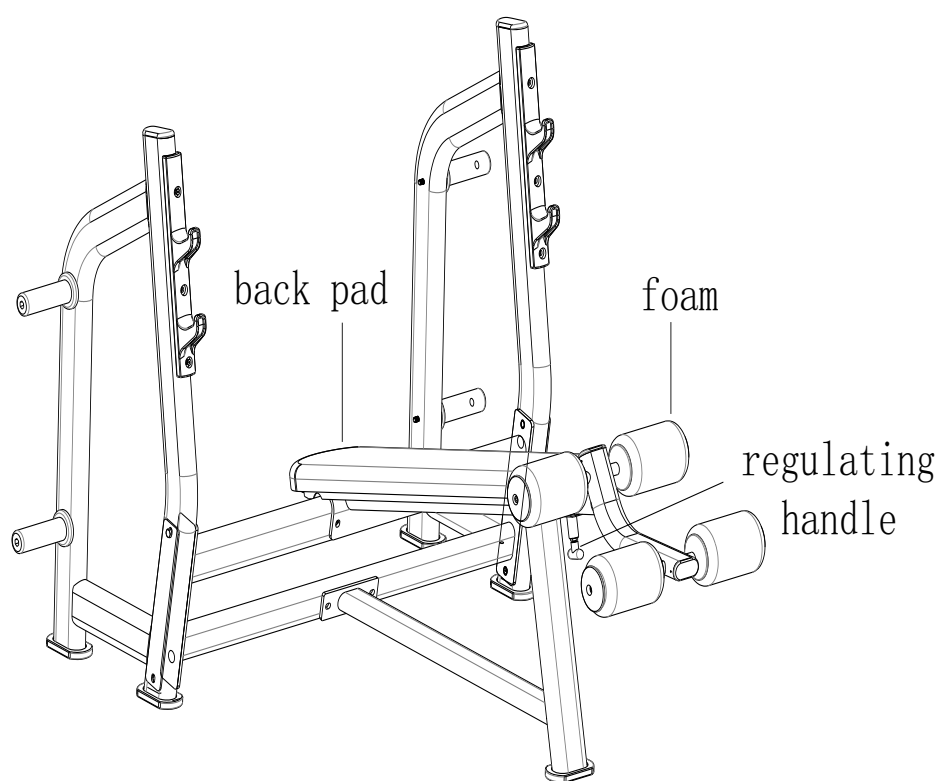



GARLANDO SPA
Via Regione Piemonte, 32 - Zona Industriale D1
15068 - Pozzolo Formigaro (AL) - Italy
www.toorx.it - info@toorx.it